

Bottom View  
1:5

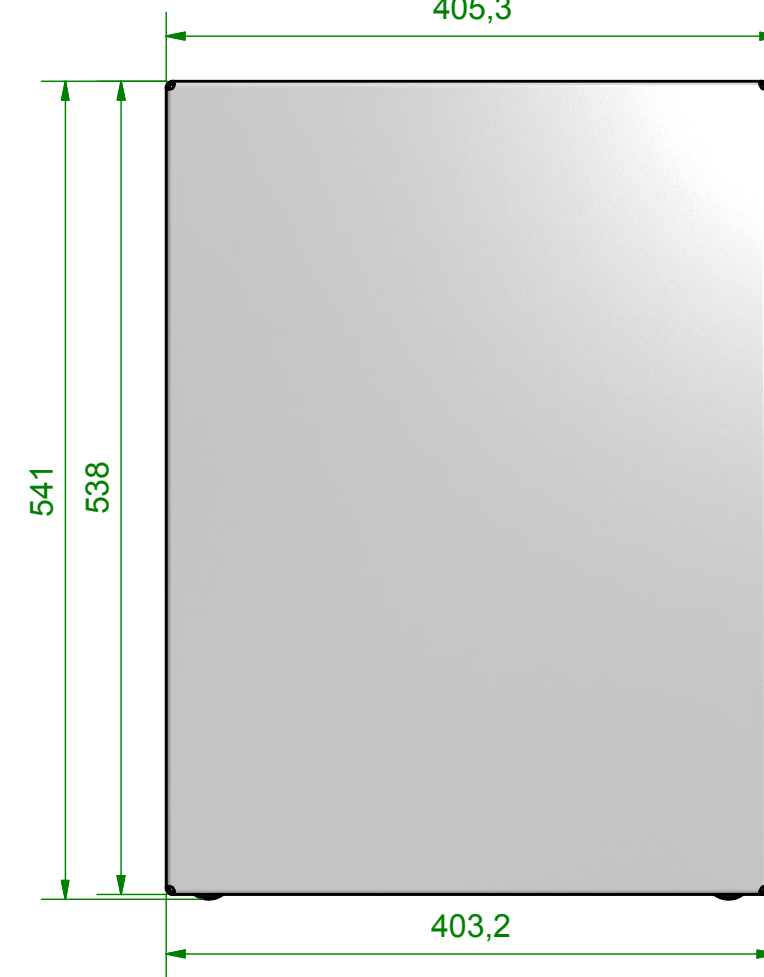

Righthand View  
1:5  
405,3



Front View  
1:5

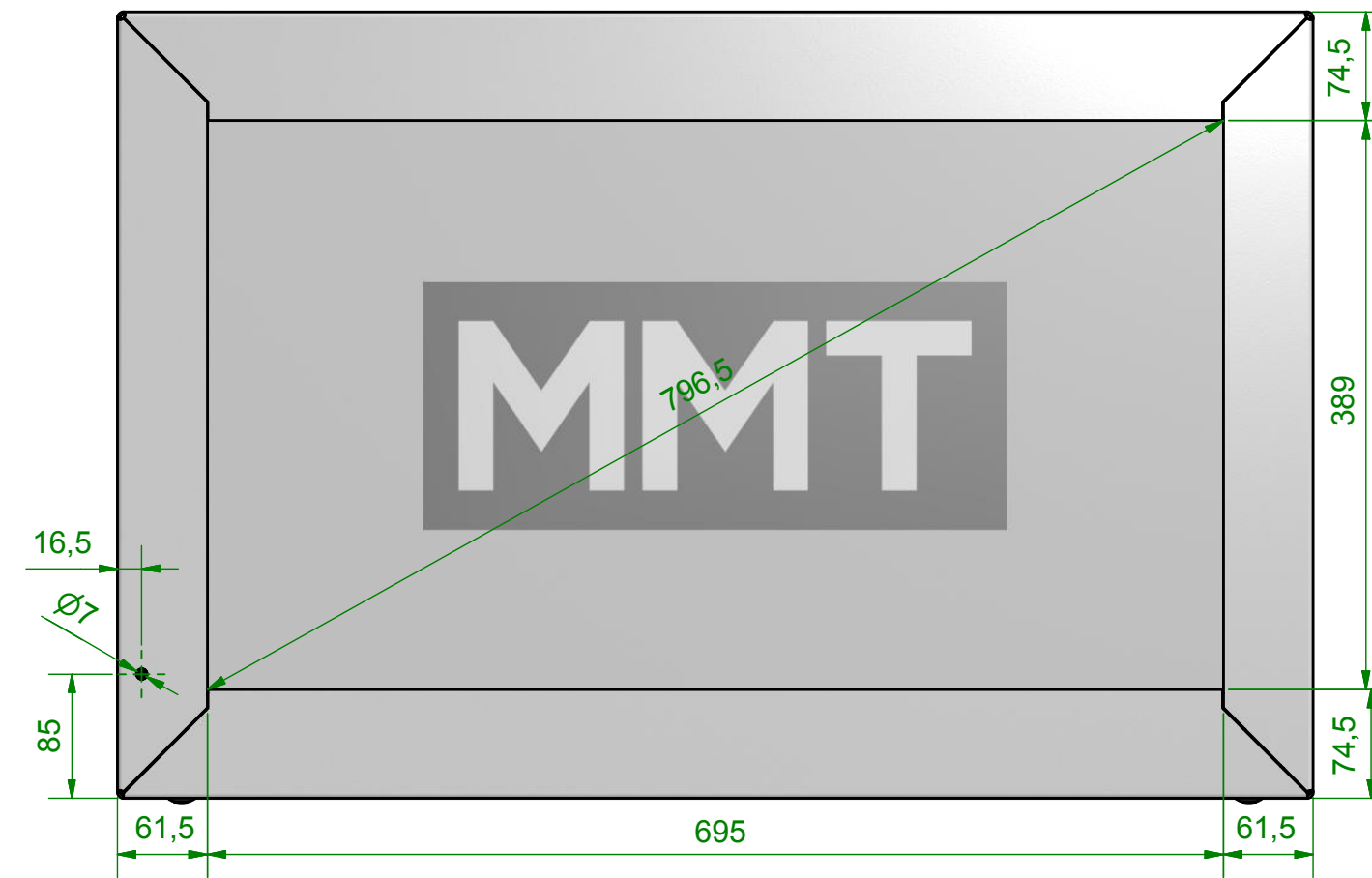

Lefthand View  
1:5

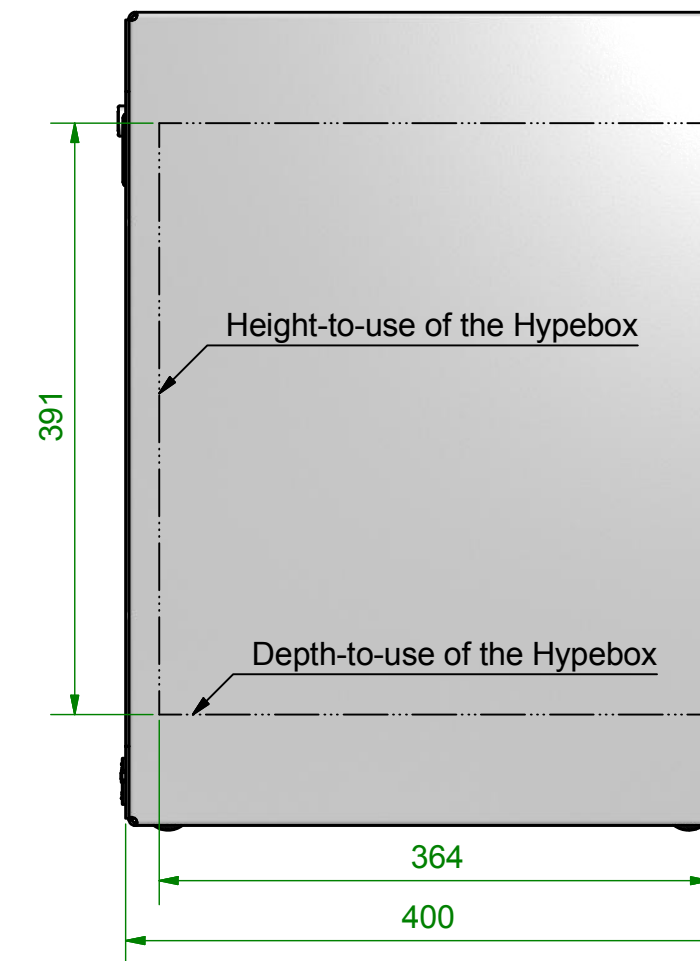

Back View  
1:5

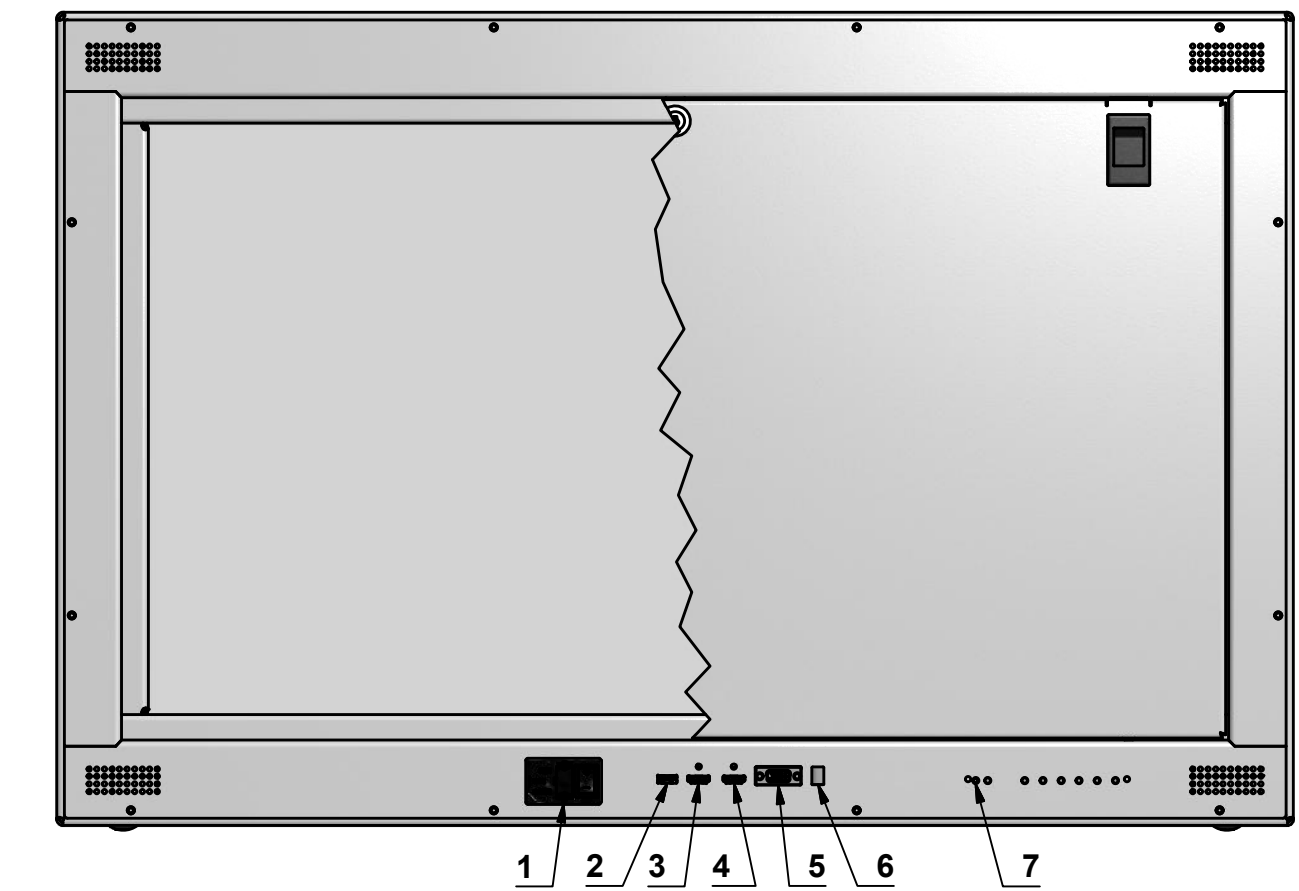

| item | designation           |
|------|-----------------------|
| 1    | PEM C14 (Power Input) |
| 2    | USB                   |
| 3    | HDMI 1                |
| 4    | HDMI 2                |
| 5    | VGA                   |
| 6    | Audio In              |
| 7    | Control Keys          |

Top View  
1:5

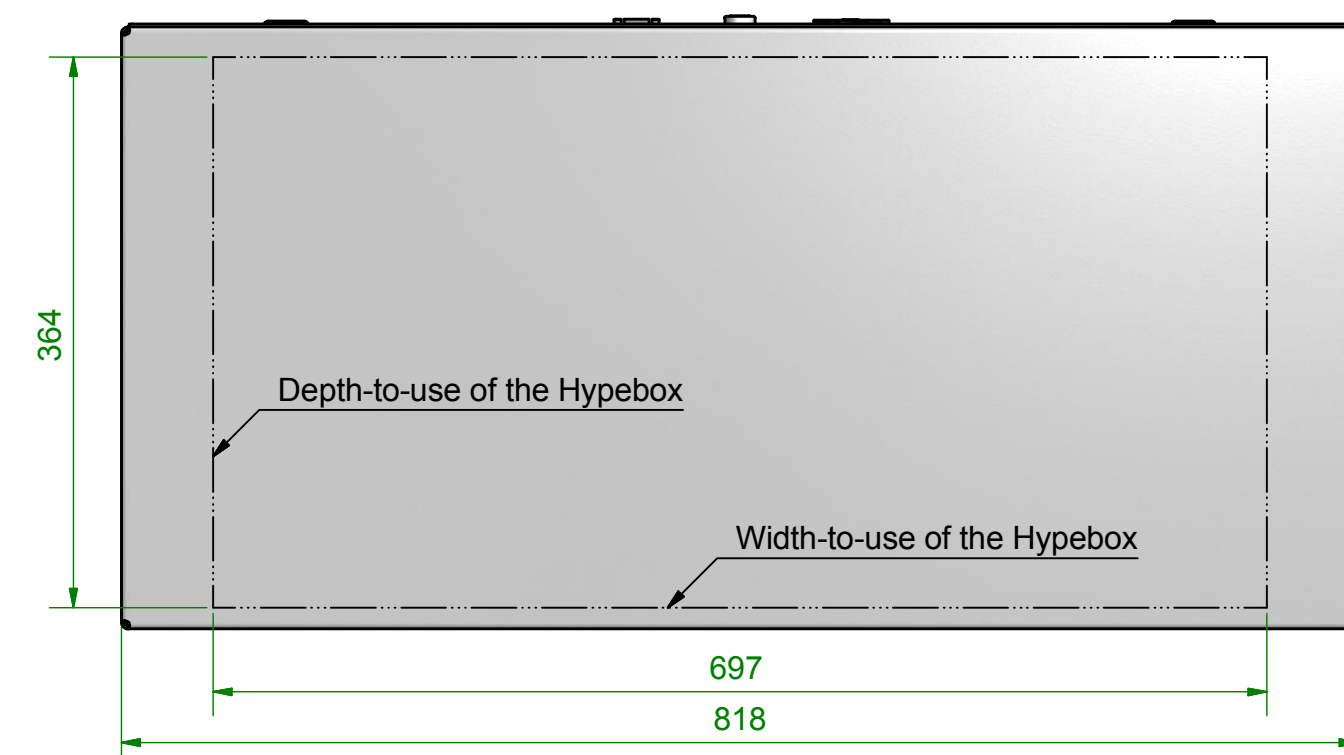

Isometric View  
1:10

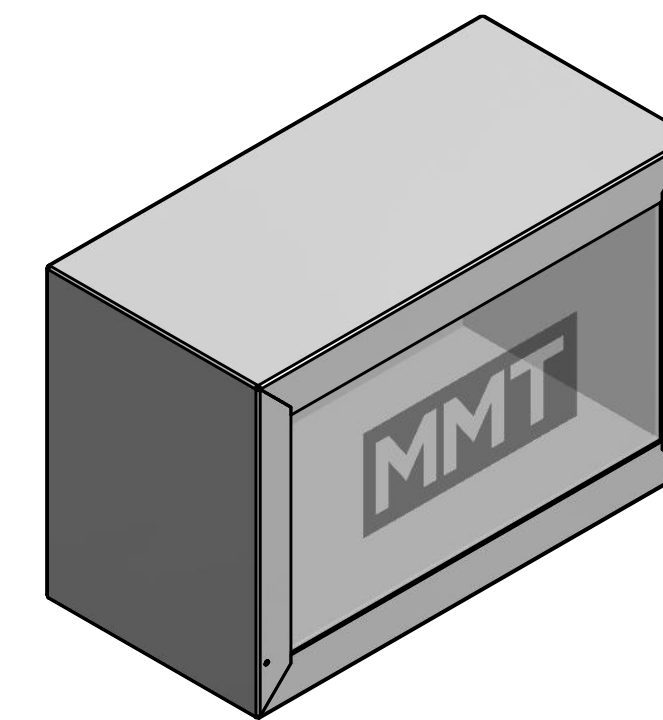

|   |  |  |
|---|--|--|
| size (inch):<br><b>32"</b>  | product / model:<br><b>Hypebox/HB32L</b> | <b>MMT</b><br>www.mmt.io   |
| drawing no.:<br><b>Hypebox HB32L</b>  | version: revision:<br><b>V1.0</b>        |  |
| <small>The copying, distribution and utilization of this document as well as the communication of it's contents to others without expressed authorization is prohibited. Offenders will be held liable for the payment of damages. All rights reserved in the event of the grant of a patent, utility model or ornamental design registration. (DIN 34)</small> |  | <small>constructed by:</small> D. Lange   <small>drawn by:</small> D. Lange   <small>checked by:</small> D. Lange<br><small>constructed on:</small> 11.02.2014   <small>drawn on:</small> 26.06.2014   <small>checked on:</small> 12.05.2015 |
| <small>measures without tolerances:</small><br>machined: DIN ISO 2768 - m   non-machined: DIN ISO 2768 - K   thermal cut: DIN EN ISO 9013 - 1   welded: DIN EN ISO 13920 - B  |  | <small>weight:</small> 18 kg   <small>scale:</small> 1:5   <small>format:</small> A1   <small>sheet:</small> 1 / 1   |